



Ensemble | electricity display

QUICK START GUIDE

Putting you in control of your electricity consumption

- View your electricity consumption in real time
- Explore how much electricity you are using
- See if you are above or below your target
- Monitor and control individual appliances

For a Simpler Start, Go To: energynote.co.uk/start

DISPLAY

1 per pack



SMART PLUGS

1 per pack



TRANSMITTER

1 per pack



SENSOR

1 per pack

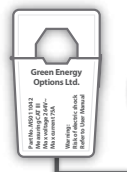

BRIDGE

1 per pack

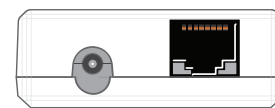



SAFETY FIRST:

Rest assured it is perfectly safe to clip the sensor onto the mains cable as the cable is fully insulated, however:

- In the event that there is not enough cable access you **MUST STOP** the installation.
- **DO NOT PULL THE MAINS CABLE** or try to force the sensor on if the cable seems too wide, instead please contact our technical support helpline (see contact details below).
- If the cables going into your electricity meter look perished (cracked, burned or you can see bare copper), are loose, wet, or you have any doubts about their condition, **DO NOT** install the sensors. Contact a qualified electrician to rectify the problem.

Step 1 – Display

1. Power the Display using the power supply provided.
2. Whenever the Display is turned ON, you will see the 'set clock' screen.
3. Use the left and right buttons on the front of the Display to adjust the time and date – then press the middle (set) button when you have finished.

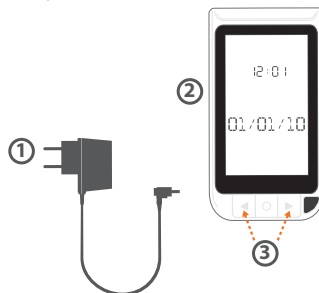

Step 2 – Transmitter

1. Open the unit by pressing the button, and pulling the outer cover away from the bottom.
2. Remove the battery tab from the Transmitter.
3. The red light will flash to show that the batteries are working.
4. On the Display, the ⚡ will light to show that it is talking to the Transmitter. If the ⚡ on the Display is flashing please refer to the user manual.

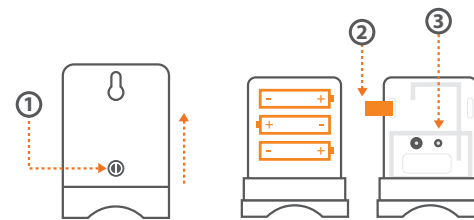

Step 3 – Smart Plugs

1. Plug your Smart Plug(s) into an available socket(s).
2. The button on the front of the Smart Plug will show one of two colours:
Green: power will be provided to the appliance.
Red: the Smart Plug is isolated and no power will be provided to the appliance.
3. The (1), (2), or (3) on the Display will stop flashing to show the Smart Plug is in range and active. If it does not, please refer to the user manual.

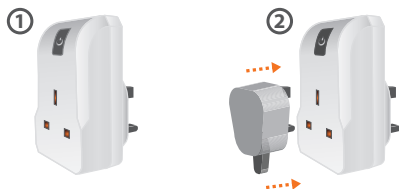

Your display can communicate with up to 6 Smart Plugs.
To purchase additional units, please contact your supplier.

Step 4 – Sensor

Single Phase Sensor:

1. At your electricity meter, clip the Sensor around the mains live cable (please refer to the user manual for examples of live cables on the meter). You should hear a 'click' to indicate the Sensor has been tightly closed.
 2. Plug the Sensor cable into the bottom of the Transmitter.
- The Display will now start to show the energy you are consuming.

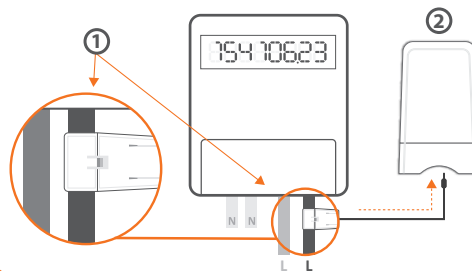

Online Service

1. Plug the power supply into a mains socket and insert the other end into the power socket at the back of the bridge.
2. Using the Ethernet cable provided, connect the bridge to your broadband router. (The bridge uses DHCP and will get an IP address automatically from your router)

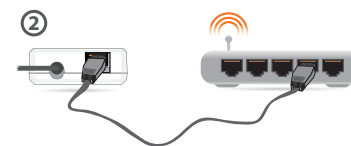

You will now be able to view your usage and control your devices online. Go to: energynote.co.uk

ENSE-A-QSG_001

